

# ULTRALIFT COVER LIFTER

## STANDARD MOUNT

### Assembly, Installation Instructions & Parts List



Byron Originals  
P.O. Box 279 Ida Grove, IA 51445  
712-364-3165 800-594-9421  
www.byronoriginalsinc.com

## Parts List

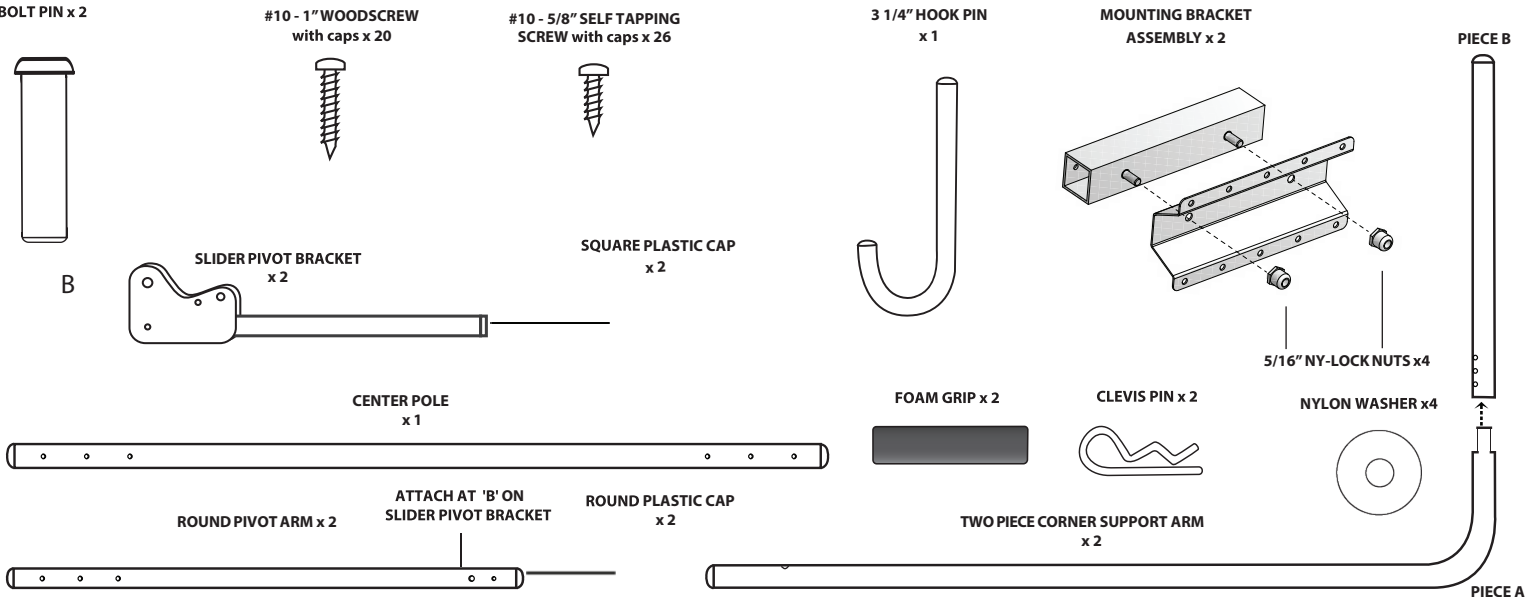

## Possible Mounting Positions

TOP MOUNT - SIDE VIEW

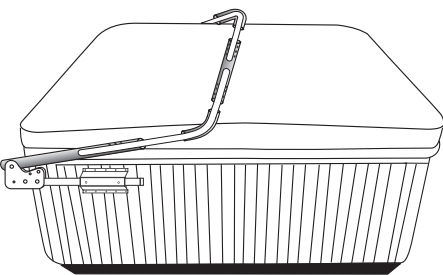

LOWER MOUNT - SIDE VIEW

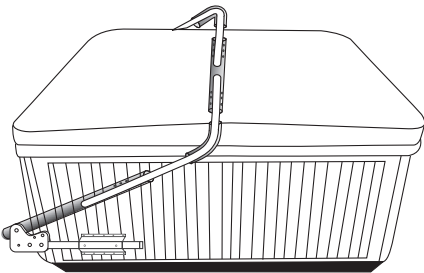

DECK OR FLOOR MOUNT ONLY - SIDE VIEW

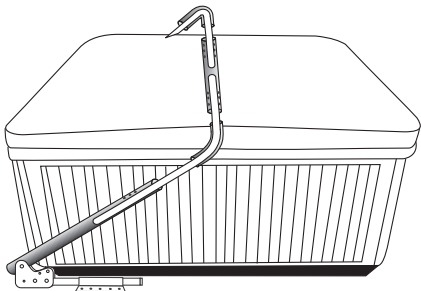

ILLUSTRATION 4  
ASSEMBLY OF CORNER ARMS TO PIVOT ARMS - FRONT VIEW

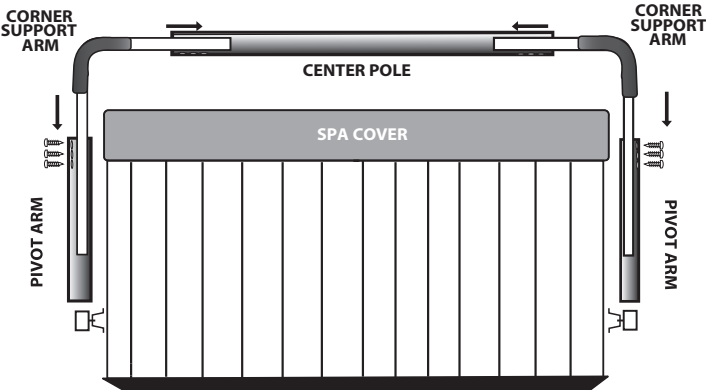
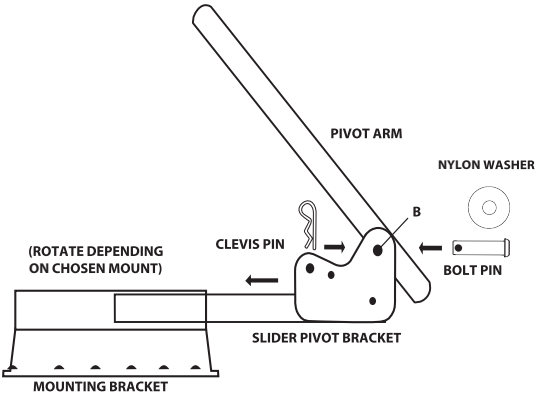
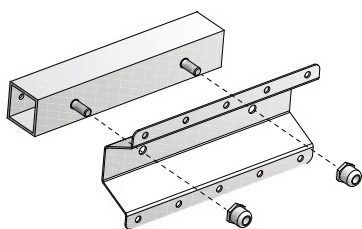

ILLUSTRATION 5  
ASSEMBLY OF SLIDER ARM TO PIVOT ARM  
SIDE VIEW



## PRE-ASSEMBLY

Illustration 1



Assemble the 2-piece mounting bracket using 2 of the 5/16 - NC ny-lock nuts.



ROUND PIVOT ARM x 2

Insert the two round plastic caps into the open end of the round side pivot arms. Insert the square plastic caps into the open ends of the slider pivot bracket.

Note: Round plastic caps may not be necessary if metal cap already exists on round pivot arm

Illustration 2

### FOAM GRIP ASSEMBLY

Before Assembly:  
Use warm water or hand sanitizer to lubricate the foam grip



Illustration 3

CONNECT THE CORNER SUPPORT ARM BY INSERTING PIECE A INTO PIECE B.

SECURE THE PIECES TOGETHER USING THREE #10 5/8 SELF TAPPING SCREWS.



## Installation Instructions

### STEP 1

The spa cover must be in the closed position prior to mounting the lifter. Position the spa cover properly so it is sitting squarely on the spa. Attach the preassembled mounting bracket (see Illustration 1) as close to the corner of the spa as possible using the #10 - 1" woodscrews. If you want the folded cover lifted above the top of the spa as a privacy screen, mount the bracket close to the top of the spa, as shown in "Top Mount" illustration. If you prefer the open cover to sit low behind the spa, mount the brackets closer to ground level, as shown in "Lower Mount" illustration. The other option is to mount the assembled standard brackets directly on the deck or floor. This will require greater clearance space behind the tub if there is a wall, fence or similar structure restricting removal of the cover. A minimum of 16" between the rear wall of the spa and any wall or fence is needed to accommodate the lower skirt, deck or undermount lifter position. We recommend pre-drilling the holes with a 1/16" drill bit.

### STEP 2

Insert the slider pivot bracket into the mounting bracket and position it so that the slider pivot bracket lines up with the back of the spa and secure using #10 - 5/8" tapping screws (see Illustration 4).

### STEP 3

Insert the corner support arms into the center pole. For a top mount, slide the longer end of the corner support arm into the centre pole. For lower mount and deck mount, slide the shorter end of the corner support arm into the centre pole.

### STEP 4

Slide the pivot arm over the corner support arm. Align the pivot arm with the holes identified as "B" on the slider pivot bracket and feed the bolt pin through the nylon washer, through the bracket, through the round pivot arm, and secure using the clevis pin (see Illustration 5). Repeat on other side.

### STEP 5

Make sure the centre pole is located 1" from the middle seam of the cover on the lifter side (see Illustration 6). We recommend rotating the centre pole so that the screws are inserted horizontally.

### STEP 6

Secure the pivot arms to the corner support arms using 6 #10 - 5/8 self-tapping screws. Cover all woodscrews and tapping screws with plastic caps. You have completed the installation of your Ultralift cover lifter

Illustration 6

Centre Pole 1" from middle of cover

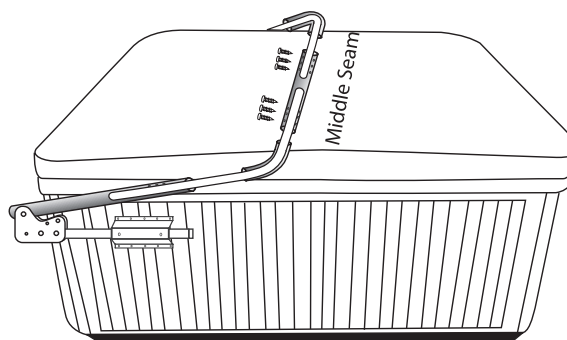

**NOTE:** The hook pin should be inserted into the pivot bracket when the spa cover is opened, for added safety, and removed to close the cover.



#### THE WARRANTY:

SMP Specialty Metal Products Inc. warrants to you (the original purchaser) for the stated warranty term of FIVE YEARS (60 Months) from the original date of purchase, to be free from defects in material and workmanship.

UltraLift Cover Lifters will be free from defects in materials or workmanship that would cause the lifter to be inoperable in normal working conditions. Any claim made within these terms for Five years from the date of purchase will be repaired or replaced at the option of the Manufacturer.

This is a 100% Non-Prorated Warranty on all parts for the full 5 years. Only parts excluded from the warranty are the gas springs which include a 100% One Year Warranty.

#### EXCLUSIONS TO WARRANTY

- Lifter has been subjected to alteration, misuse or repairs by anyone other than an authorized representative of the Manufacturer, unless written approval is provided
- Damage caused by improper installation or during transportation from the seller to the purchaser
- Any damage resulting from any misuse, abuse, negligence, accident or alteration, environmental, or use during high winds

The warranty covers the operational use of the lifter but does not cover scratches, abrasions, rusting or any defects to the finish of the material caused by or resulting from the exposure to the environmental factors; i.e. sun, rain, chemicals or any defects resulting from normal fading or minor deterioration.

The warranty does not cover damage resulting from abuse or accidents, including but not limited to the following damage:

- Use of abrasive or unapproved cleaners that could cause surface damage
- Subjection to solvents or other chemicals which could deteriorate painted surfaces
- Use for any other purpose than as a Spa or Hot tub cover lifter

#### MAKING A CLAIM:

To make a warranty claim; in the event of a defect covered by this warranty for UltraLift, contact the original retail seller and provide original purchase receipt, any photo(s) clearly showing the defect(s) and an explanation. NO RETURNS OF MERCHANDISE WILL BE ACCEPTED UNTIL A "RETURN AUTHORIZATION NUMBER" HAS BEEN ISSUED.

The lifter will be repaired or replaced at the discretion of the Manufacturer. If necessary, the purchaser is responsible to ship any said parts back to the manufacturer. The warranty includes all Labor costs performed at the manufacturer's facility but not labor in the field. SMP will cover the cost(s) to repair and/or replacement of the items back to the retailer or seller.

#### FREIGHT DAMAGE:

Any materials damaged in freight will be replaced by SMP Specialty Metal Products provided the purchaser files the appropriate claims form with the carrier, and submits copies to the manufacturer within five (5) business days of receiving the damaged merchandise. All claims should also be reported to the seller.

#### Consequential Damages:

SMP Specialty Metal Products Inc. will not be liable for any loss, expense, or damage other than to UltraLift, that may result from a defect in materials or workmanship. This warranty does not cover incidental damages including damage to property or injury arising from the use or inability to use this product. Manufacturer or Seller shall in no event be liable for any amount in excess of the original purchased amount. (Some Provinces / States do not allow the exclusion or limitation of incidental or consequential damages, so the above mentioned limitation may not apply to you).

It is important that you report to the Retailer from whom you purchased UltraLift, any defects as soon as they are detected. If it is impractical to report any defects to the Retailer, Contact **SMP Specialty Metal Products Inc. 326 Watline Avenue, Mississauga, Ontario Canada, L4Z 1X2; Phone: 1-800-597-1343, Email: [info@theultralift.com](mailto:info@theultralift.com)**